

OPPEIN

OPPEIN HOME GROUP INC.

Add: #366, Guanghua 3rd Road, Baiyun District, Guangzhou, China
www.oppeinhome.com

+86-20-36730513 sales@oppein.com

f in @ Oppein Home



360° Kitchen Showroom



360° Bathroom Showroom



360° Door Showroom



OPPEIN

KITCHENS
The World's Largest Cabinetry Manufacturer



CONTENTS

001	2023 New Arrival	055	Lacquer
027	Sintered Surface	061	Spray Lacquer
033	Solid Wood	067	UV Lacquer
037	Wood Veneer	079	Melamine
045	PET	095	PVC Foil
049	HPL	105	PP Foil

ABOUT OPPEIN

Founded in 1994, OPPEIN is China's No.1 kitchen and customized home decor brand, and the world's largest cabinetry manufacturer. We design and manufacture high-quality kitchens, wardrobes, bespoke home furniture, bathroom products, interior doors, aluminum windows & doors and home furnishing, capable of offering one-stop home decor products and solutions. Output and sales of kitchen cabinet reached 850 thousand sets, ranking No.1 in the kitchen industry.

In 2022, OPPEIN's sales turnover reached USD 3.24 billion, harvesting its consecutive 29th years of growth. Output and sales of cabinets reached 6 million sets, ranking No.1 in the cabinetry industry. Our products have been exported to 118 countries and regions, and the total market value of OPPEIN exceeded 100 billion yuan (USD 15.3 billion) in March 2021.

In overseas markets, what sets us apart from our competitors is our Italy design, European quality, one-stop whole-house products & solutions, and reliable local services.

OPPEIN takes great pride in its extensive franchise distribution system. We have a productive showroom operation model and thoughtful support policies to help the franchisees win. Currently, we have a remarkable number of over 7,500 franchise showrooms worldwide to serve local retail businesses.

The global project business is another importance we attach to. We cooperate closely with builders, developers, contractors, and architects to develop different types of residential and commercial business; up to now, we have completed over 10,000 real estate projects around the globe, including some significant local landmark projects.

We achieve this through our unceasing striving for perfection, and the passion to satisfy an individual's needs for better home decor. Our vision is to make OPPEIN a modern, innovative company respected and loved by the people, held in the highest esteem in China, and emulated around the world.

Where there is home and love, there OPPEIN is.



- 1 Guangzhou Headquarter**
Established in 1994, with 444,000m²
- 2 Tianjin Factory**
Established in 2011, with 335,100m²
- 3 Wuxi Factory**
Established in 2015, with 519,400m²
- 4 Qingyuan Factory**
Established in 2017, with 989,300m²
- 5 Chengdu Factory**
Established in 2019, with 496,000m²
- 6 Wuhan Factory**
Under construction, with 507,000m²



1994

Establishment

China's first modern factory to custom make kitchen

1999

Brand Influence

Ranking No.1 both in kitchen sales turnover and brand influence in China

2003

Kitchen Standards

-The first to be selected as "the Drafting Unit of China's Residential Kitchen Standards"
-Setting up its USA office in Boston and starting to explore overseas markets

2009

Guangzhou HQ

-The first to be honored with "China Well-Known Trademark" in the industry
-1,100+ global showrooms
-Covering a total area of 444,000 SQM, OPPEIN Guangzhou HQ is put into use.

2011

The Largest Cabinetry Manufacturer in Asia

-Tianjin factory with a total area of 335,100 square meters in put into operation
-Becoming Asia's largest cabinetry manufacturer based on both factory size and production capacity

2007

China Top Brand

-The first to be honored with "China Top Brand" in the industry
-118 exporting countries

2018

6800 Showrooms

-OPPIEN has 6,800+ showrooms worldwide
-OPPEIN has fulfilled 10,000+ real estate projects worldwide ever since 1994

2021

Market Value Breakthrough

-The total market value of OPPEIN exceeded USD 15.3 billion in March 2021.
-Reddot award 2021 winner

Whole house Customization

-China's first to initiate and offer whole- house customization solution
-Setting up offices in India, Philippines, Australia, Kenya and Milan

2014

2017

Went Public

-Going public in Shanghai Stock Exchange
-Qingyuan factory with a total area of 989,300 square meters is put into operation

2020

Output No.1

Output and sales of kitchen cabinet reached 830 thousand sets, ranking No.1 in the kitchen industry.

2022

Brand Acquisitions

Successfully acquired Italian high-end home furnishing brand FORMER, and launched a new high-end brand miForm.

2015

Wuxi Center

Located in East China, OPPEIN Wuxi manufacturing center, with a total area of 519,400 SQM, is put into use.

COMPANY MILESTONES

China's No.1 Kitchen & Customized Home Decor Brand
The World's Largest Cabinetry Manufacturer



WALDEN PLCC23026

Wood Veneer

Door Style: YMN079, YMN080, YMN081

Door Finish: PWMN2001

Countertop: PWTE0086, PWTY2013

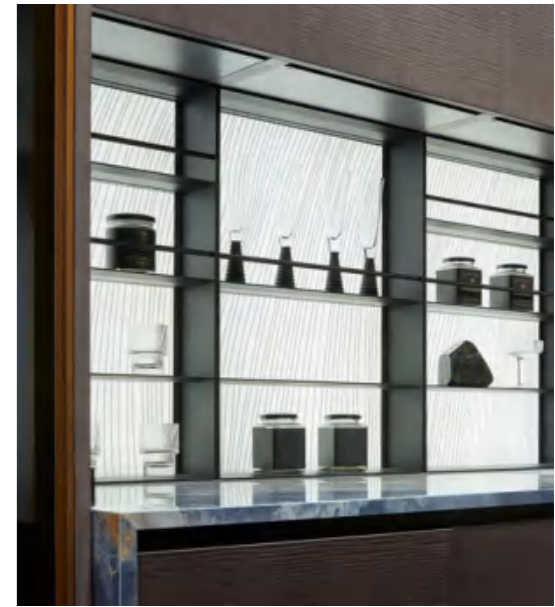
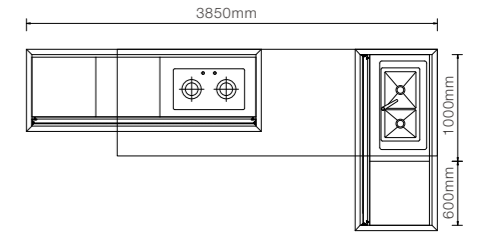
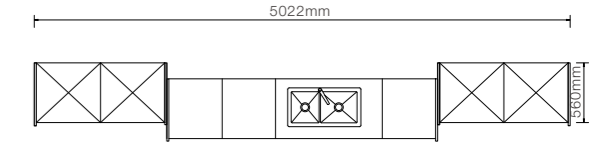

GREENBERG PLCC23020

Wood Veneer

Door Style: YMN082, YMN083, YMN001

Door Finish: PWMN1001

Countertop: PWTE0005

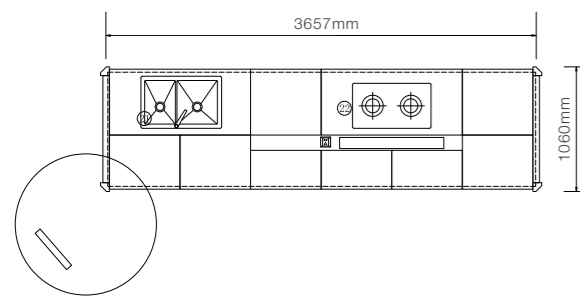
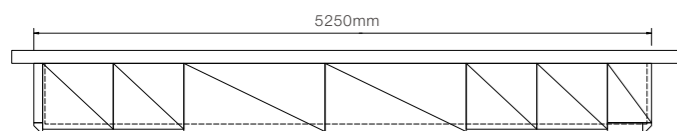

SAMPLE
ORPEIN



SAMPLE
OPPEIN

SOMMAROY

PLCC23028

PET

Door Style: YMP053, YMP001P, YMA001P
 Door Finish: PWMP2033, PWMP2032, PWMA0545
 Countertop: PWTY1048

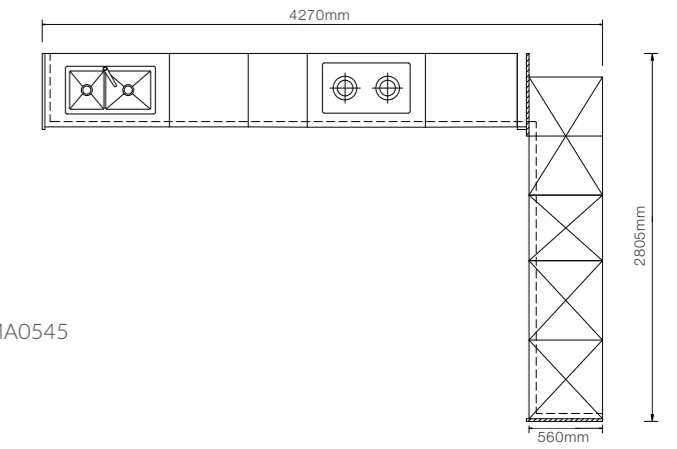

MAESTRO PLCC23030

PET

Door Style: YMD077, YMG231
Door Finish: PWMP2031, PWMP2030
Countertop: PWTE0048

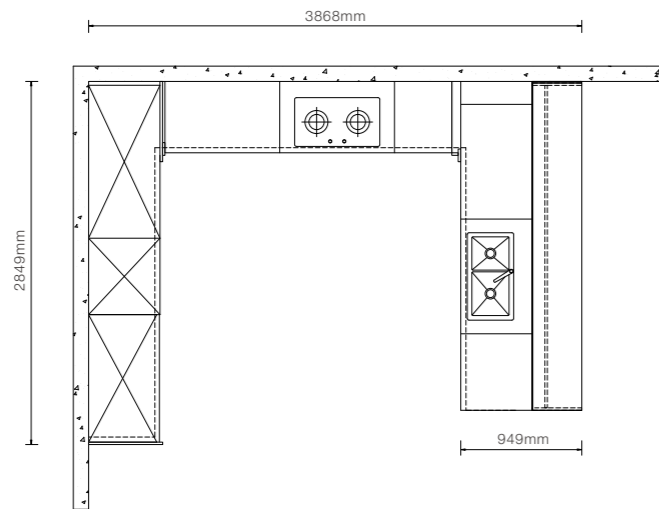



HOUMAS PLCC23024

Lacquer

Door Style: YMK001, YMK300

Door Finish: PWMK2176

Countertop: PWTE0088

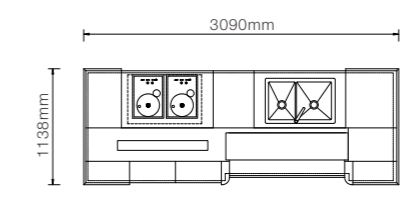
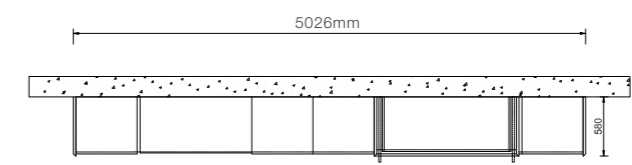

GLENDURGAN PLCC23022

Spray Lacquer

Door Style: YMH107, YMH108, YMH109, YMH001

Door Finish: PWMH0070, PWMH0071

Countertop: PWTY1111

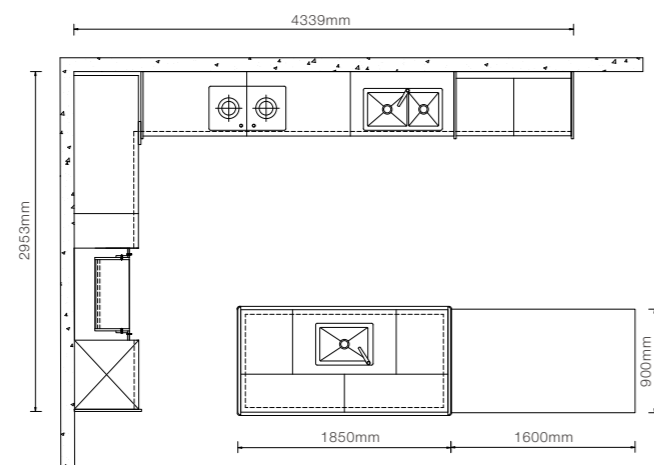

SAMPLE
OPPEIN



NITA PLCC23023

Spray Lacquer

Door Style: YMH104, YMH105, YMP054

Door Finish: PWMH0072, PWMH0066

Countertop: PWTY1111

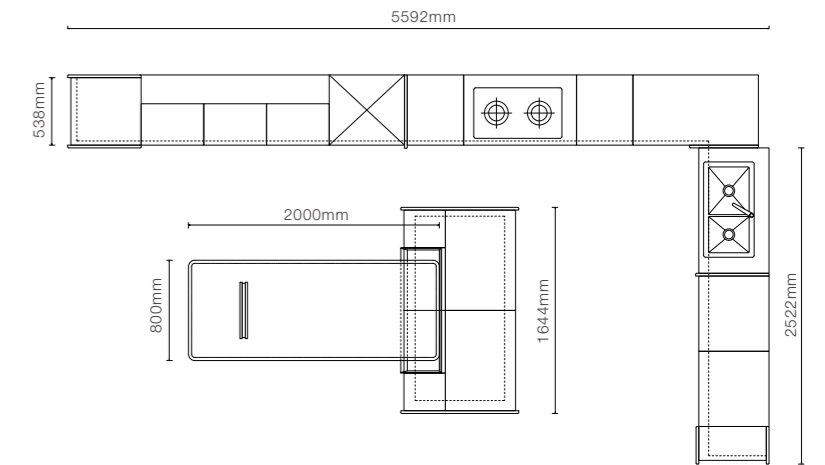

AURORA PLCC23040

Melamine

Door Style: YMA001P

Door Finish: PWMA0537, PWMA0536, PWMA0237

Countertop: PWTY1107

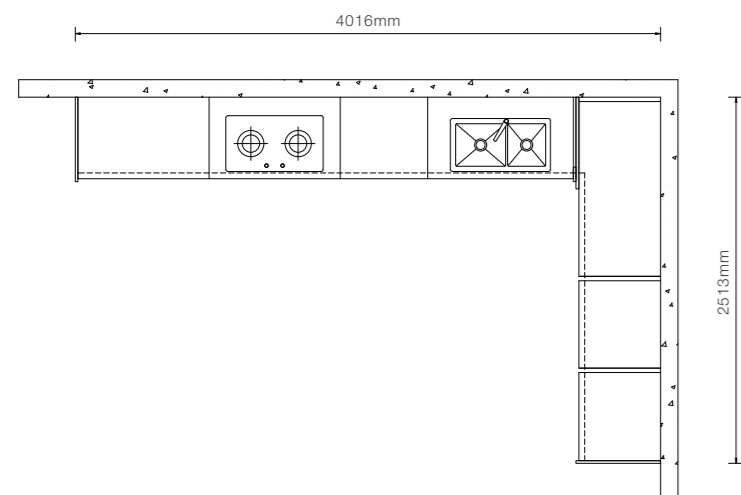



BROCADE PLCC23039

Melamine

Door Style: YMA119, YMA120, YMA001P

Door Finish: PWMA0539, PWMA0538

Countertop: PWTY1110

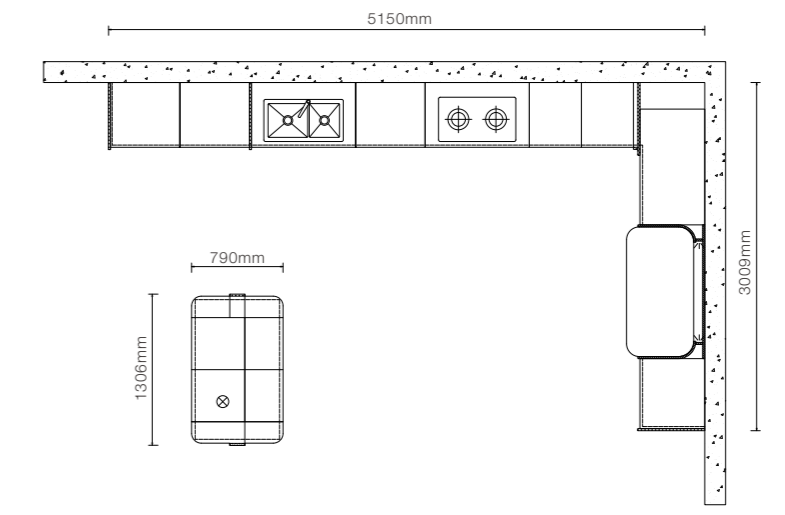

SAMPLE
OPPEIN

FEICHE PLCC23003

PVC Foil

Door Style: YMG065, YMC003

Door Finish: PWMG1383, PWMG1382, PWMC0160

Countertop: PWTE0048

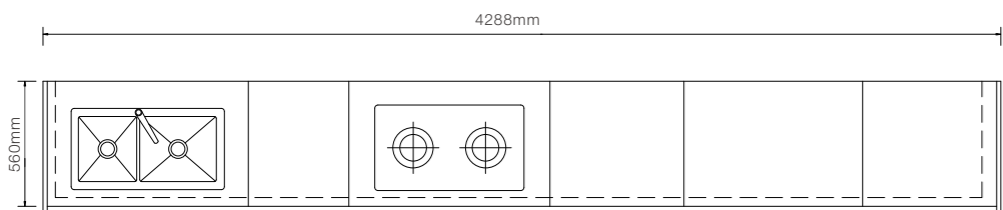



SICILIAN HOLIDAY

PLCC23031

PVC Foil

Door Style: YMG227, YMG228, YMG229, YMG230

Door Finish: PWMG1385

Countertop: PWTE0084

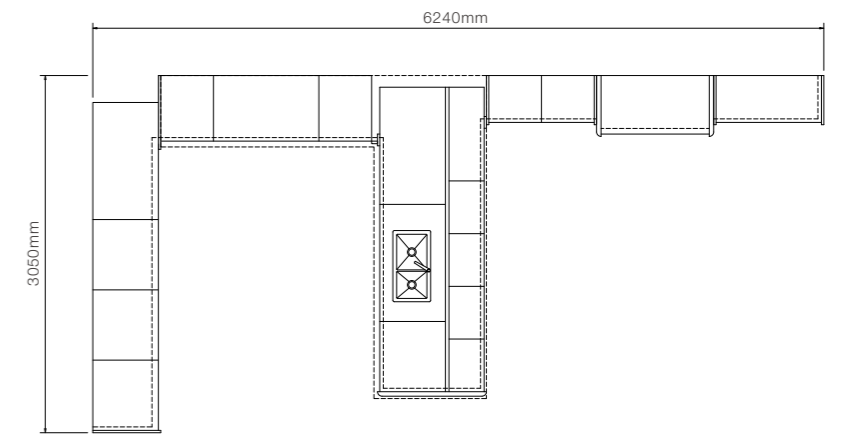

SAMPLE
OPPEIN

MOYEN PLCC23033

UV Lacquer

Door Style: YMC048, YMC003P

Door Finish: PWMC0161, PWMC0162, PWMC0164

Countertop: PWTE0022

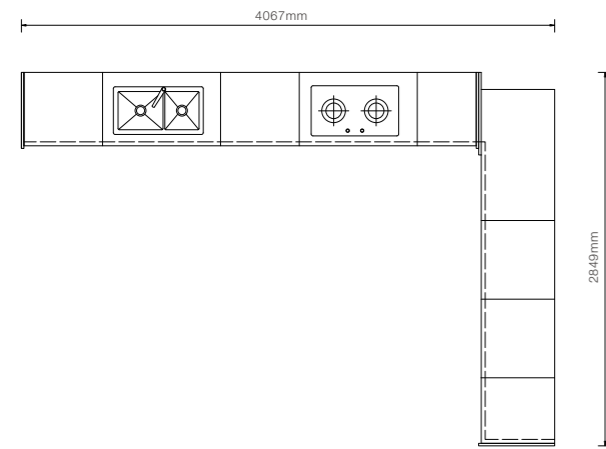



SONG FOR YOU PLCC23034

UV Lacquer

Door Style: YMC003P, YMA001P
Door Finish: PWMC0163, PWMA0237
Countertop: PWTY1048

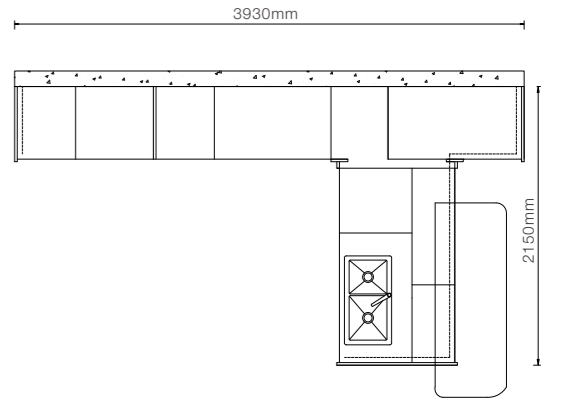

SAMPLE
OPPEIN



RIPPON PLCC22212

Sintered Surface

Door Style: YME004, YMK001
 Door Finish: PWME0008, PWMK5004, PWMK5005
 Countertop: PWTE0041, PWTE0040

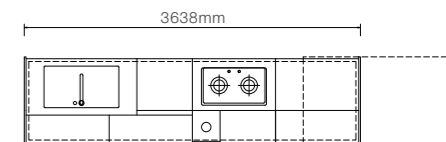
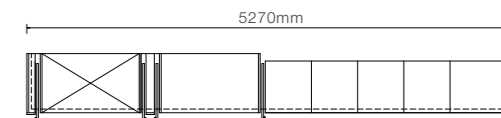

GOETHE PLCC22001

Sintered Surface

Door Style: YME017, YME018, YMG153

Door Finish: PWME0013, PWMG0258

Countertop: YTE001A, PWTE0030

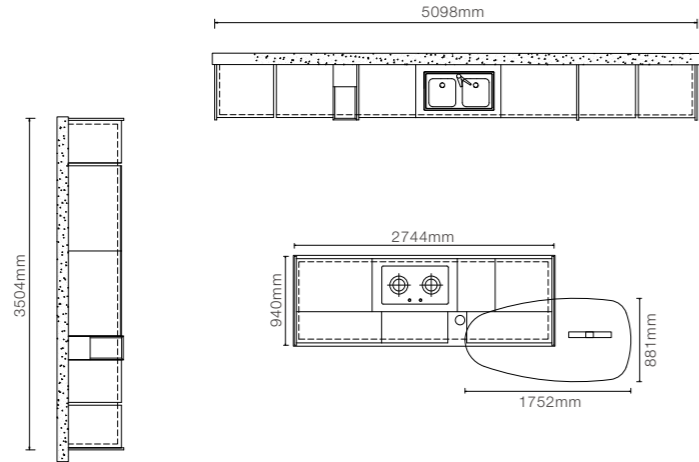



LEYAH PLCC22011

Sintered Surface

Door Style: YME015, YME016, YME019, YMN052
Door Finish: PWME0020, PWMN3066
Countertop: YTS005A, PWTY2020

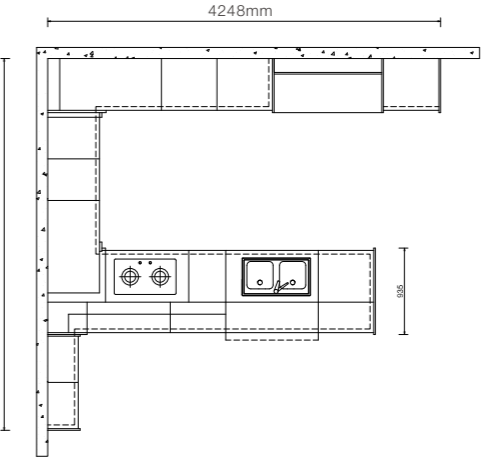

SAMPLE
OPPEIN

SCOTTISH COUNTRYSIDE

PLCC13344

Solid Wood

Door Style: YMM004

Door Finish: PWMM2014

Countertop: YTS006B, PWTY2019

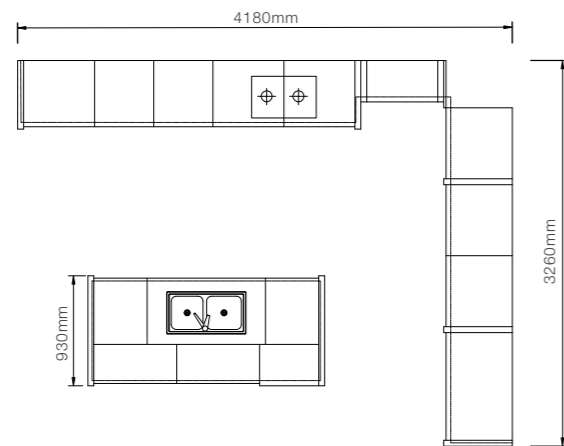



ANNECY TOWN PLCC16120

Solid Wood

Door Style: YMM035A, YMM035B

Door Finish: PWMM2023

Countertop: YTS004B, PWTY2006

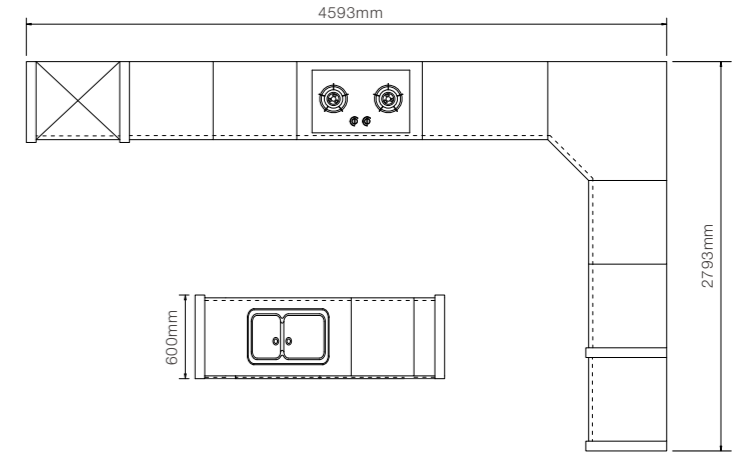



NIER PLCC22026

Wood Veneer

Door Style: YMN001
Door Finish: Wood Veneer PWMN0005, PWMN0006
Countertop: PWTE0022

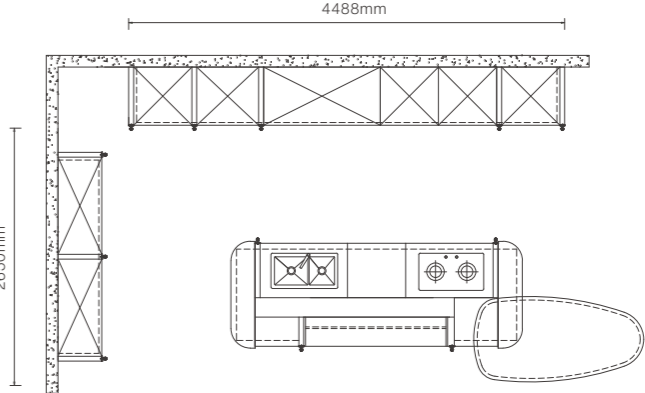

ELEGANT BLOSSOM

PLCC20103

Wood Veneer

Door Style: YMM090

Door Finish: PWMM2092

Countertop: YTE001D, PWTE0023

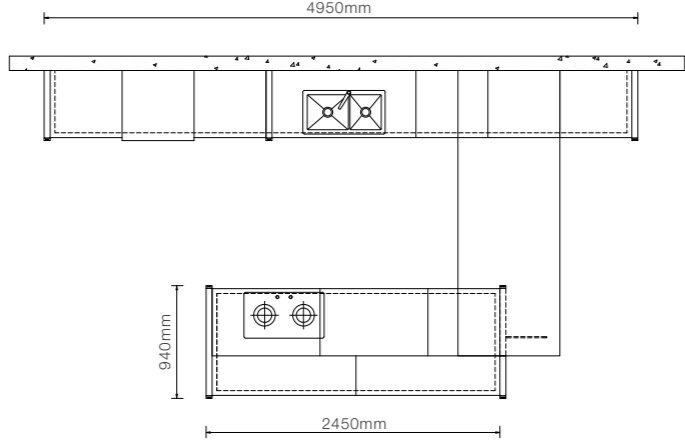



RODIN PLCC22031

Wood Veneer

Door Style: YMN053, YMN054

Door Finish: Wood Veneer PWMN0008, PWMN0009

Countertop: PWTE0005

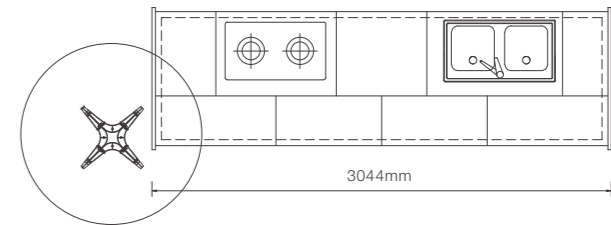
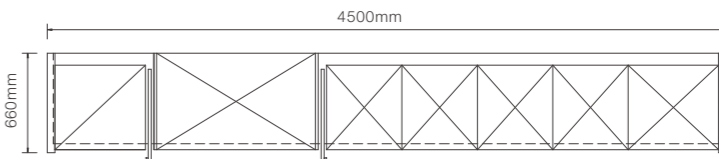

MUNCH PLCC22025

Wood Veneer

Door Style: YMN055, YMN049, YMB067

Door Finish: PWMM4007, PWMM4008

Countertop: YTE001D, PWTE0023

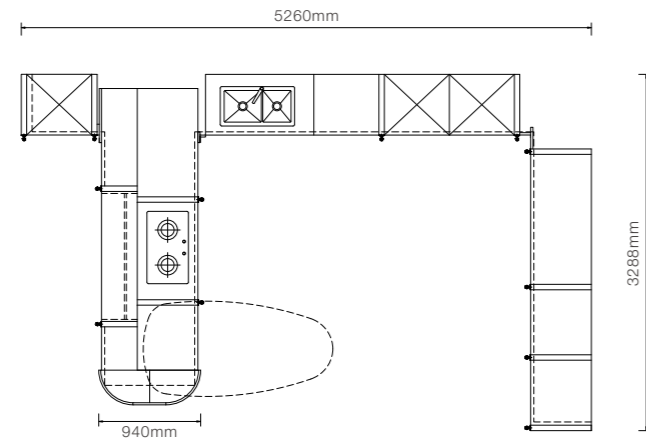



LIGHT AND SHADOW PLCC21406

PET

Door Style: YMP001, YMP027

Door Finish: PET PWMP2010

Countertop: PWTE0006

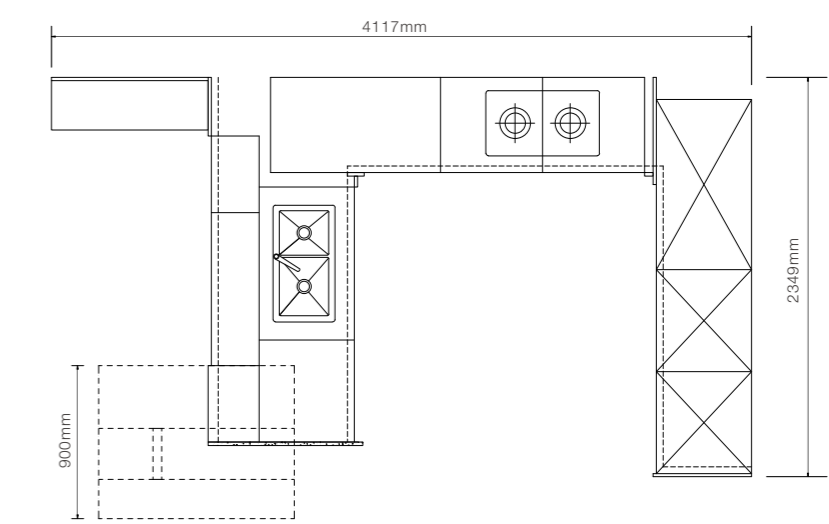

BREEZY PLCC22126

PET

Door Style: YMP001, YMK001

Door Finish: PET PWMP2024, PWMP2025

Countertop: PWTE0067

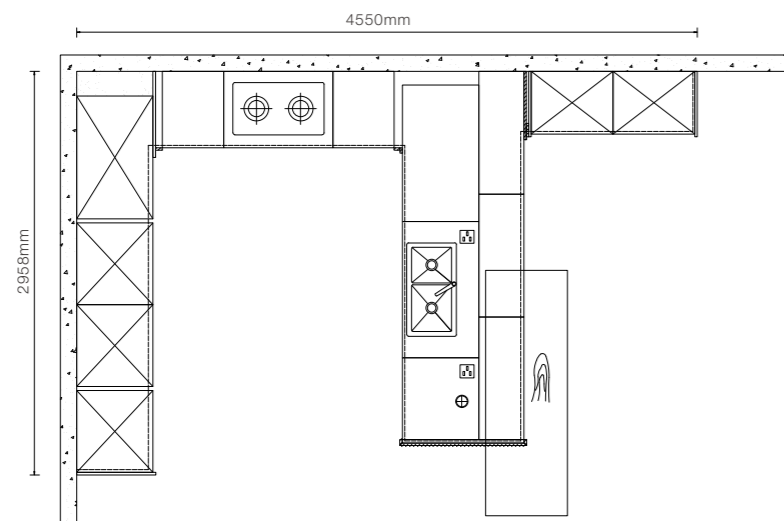

ODE TO JOY PLCC18082

HPL

Door Style: YMF001

Door Finish: HPL PWMF0047, PWMF0017

Countertop: PWTY1008

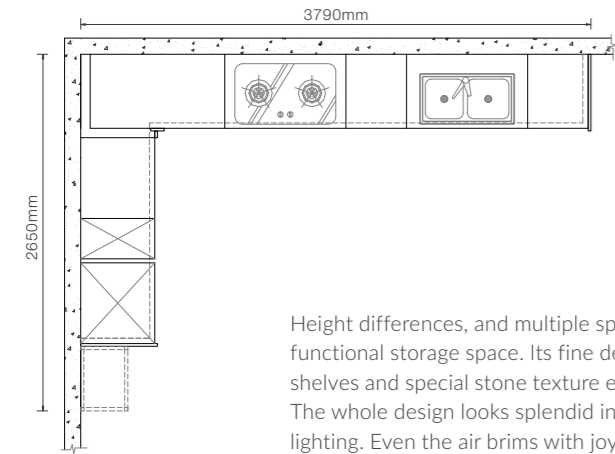

Height differences, and multiple space levels, enable clear divisions of functional storage space. Its fine details including glass doors, metal shelves and special stone texture elements, reveal its striking industrial style. The whole design looks splendid in white, and dazzlingly beautiful with the lighting. Even the air brims with joy and ecstasy.





CLOUD RETREAT PLCC21411

HPL

Door Style: YMF018, YMF001

Door Finish: PET PWMF0072, PWMF0074

Countertop: YTE002A, PWTE0036



ZEPPELIN PLCC21113

HPL

Door Style: YMF001

Door Finish: HPL PWMF0064, PWMF0065

Countertop: PWTE0034

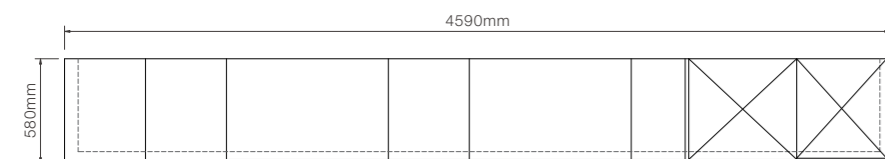

The use of stone texture and wood grain texture makes the kitchen more organic as a whole. With the concept of nature introduced into this kitchen design, it reveals a preference for naturalness and simplicity. Various forms of cabinet combination are applied to make full use of kitchen space. Multiple options of materials and lights enable young consumers to embrace a myriad of styles and tastes, with an open attitude to new and experimental ideas.



SAMPLE
OPPEIN



SECRET GARDEN PLCC21043

Lacquer

Door Style: YMK148A/B, YMK001, YMK150A/B

Door Finish: Matte Lacquer PWMK5001, PWMK2112

Countertop: PWTE0008

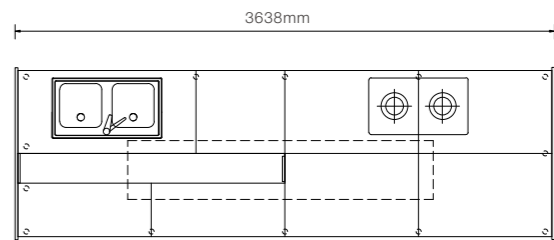
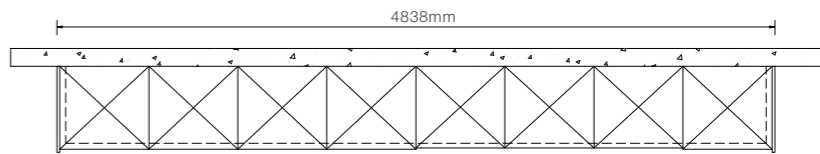

ENCHANTED DREAMS

PLCC21325

Lacquer

Door Style: YMK146A, YMK146B

Door Finish: PWMK3022

Countertop: YTE004, PWTE0007

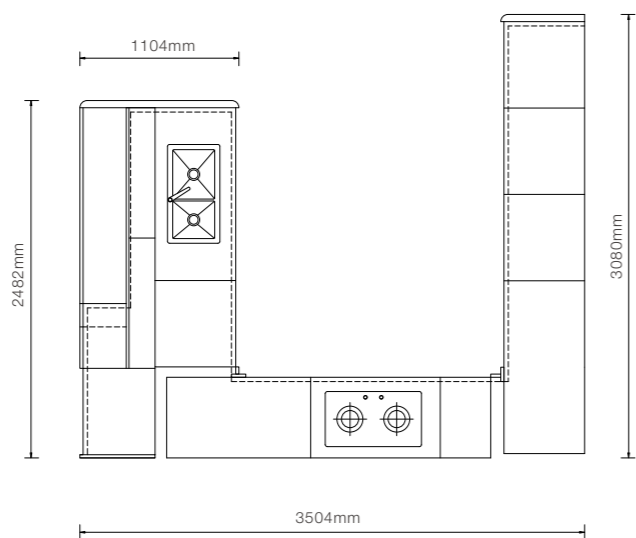



ELYSEES PLCC20016

Lacquer

Door Style: YMK001, YMC004

Door Finish: Lacquer PWMK1053, UV Lacquer PWMC0032

Countertop: PWTE0005

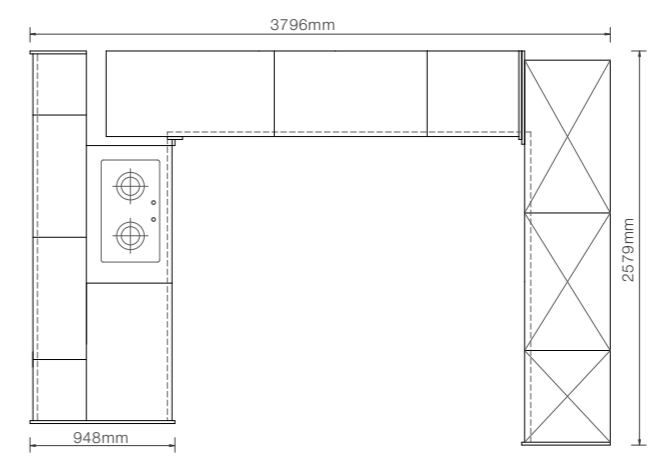

A muted palette of gray lacquer matches the skin-like wood grain texture, and seems harmonious with ultra-narrow aluminum frame in champagne color. A clear and graceful silhouette begins manifesting itself with those simple lines. Stepping into this bright and refreshing kitchen, you may feel as if you were wandering on Avenue des Champs-Élysées, known as world's most beautiful avenue.



TITIAN PLCC22196

Spray Lacquer

Door Style: YMK185A/YMK186A, YMK001G

Door Finish: Spray Lacquer PWMK7004, PWMK7021

Countertop: PWTE0031

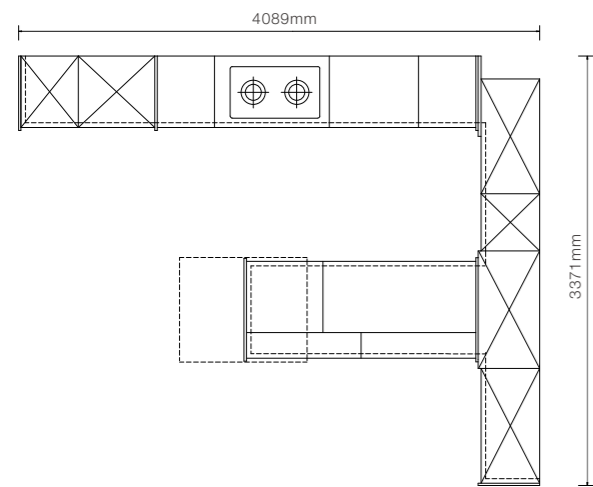



ANNE PLCC22104

Spray Lacquer

Door Style: YMK192, YMK188B, YMG173, YMK188A

Door Finish: Spray Lacquer PWMK7020, PWMG0260

Countertop: PWTE0067

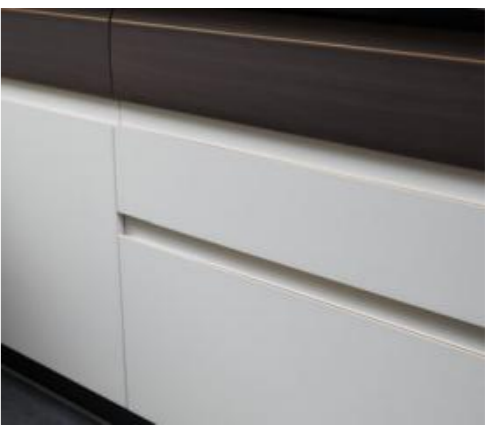
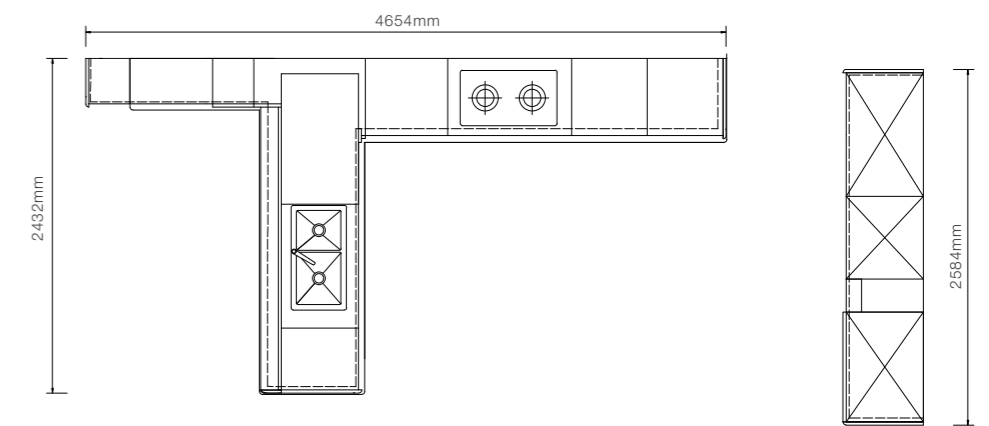

TANGULA PLCC20032

Spray Lacquer

Door Style: YMK122A

Door Finish: Spray Lacquer PWMK7005, Melamine PWMA0122

Countertop: PWTE0008

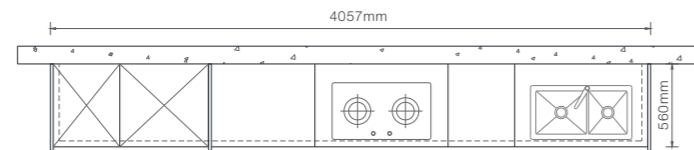

The clean door panel and concealed handle become an integrated design. The design of the unique curved door panel makes the kitchens more beautiful. Simple dark green door panels merged with wood grain back panels, present the Scandi-industrial style perfectly. Brand new lacquer material is not only environmentally-friendly but also practical. And compared to the common lacquer, it's more cost-effective.





SWAN LAKE PLCC21128

UV Lacquer

Door Style: YMC018, YMK001
 Door Finish: UV Lacquer PWMCO061, Lacquer BWMK2011, Melamine PWMA0127
 Countertop: PWTY1031

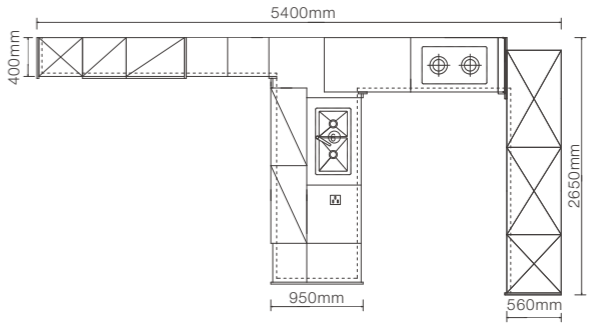

The design idea is drawn from Swan Lake by Tchaikovsky. As a ballerina in white dress, with her black veil, enters a moonlit clearing in the forest, there she dances and rises like a magnificent swan in flight. Her swaying dress has stirred up an ever-widening circle of ripples. Shadow falls on the lake, disperses with water until it finally drifts away into the morning haze. It seems that everything is immersed in an air of tranquility and elegance.



BEIRUT PLCC22194

UV Lacquer

Door Style: YMC003, YMG002, YMA001

Door Finish: UV Lacquer PWMC0112

Countertop: PWTE0031, PWTE0049

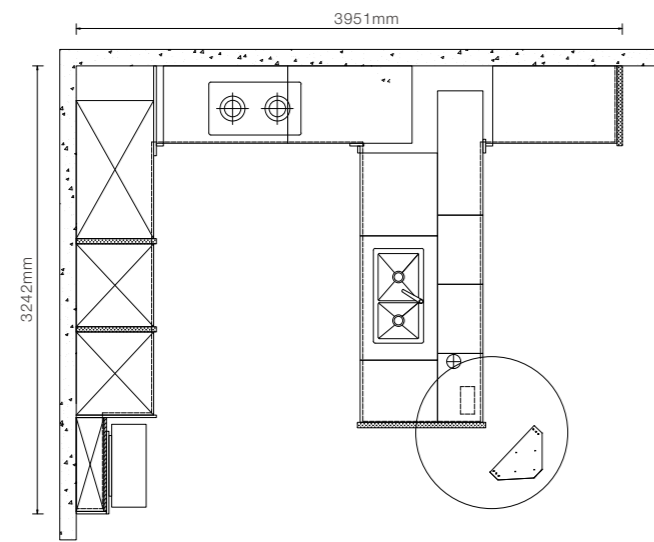



MAGIC Q IV PLCC21405

UV Lacquer

Door Style: YMC020, YMC010, YMC003, YMF001, YMA001
 Door Finish: UV lacquer PWMC0081 Countertop: PWTE0008

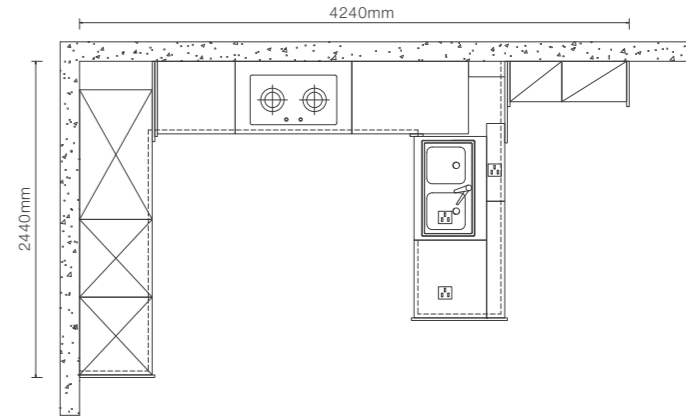

Magic Q IV is designed based on the needs of young generation, post-90s generation in particular. More creative and practical functions are added to it for the sake of comfort and convenience, epitomizing the spirit of pragmatism. Both its social functions and visual appeals are fully developed in this kitchen. It can be adapted for any forms of gatherings and social activities, catering to a new living style among young people.



SERENADE PLCC21339

UV Lacquer

Door Style: YMC003/YMC017, YMA001

Door Finish:

UV Lacquer PWMC0060, Melamine PWMA0119

Countertop: PWTE0034

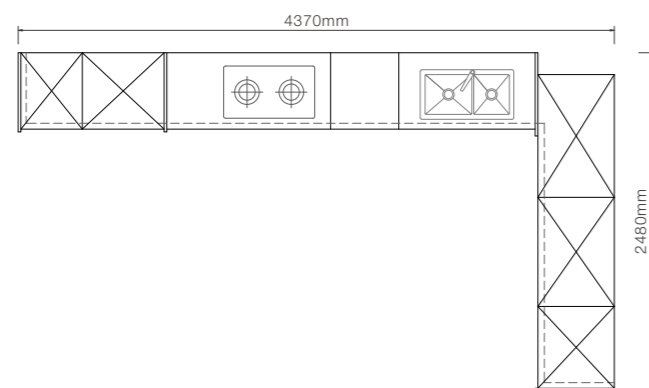

Neutral grey color and wood grain texture is a classical colour combination that manifests an attitude of modesty. Rows of thickened shelves line up with glass doors, bringing about a sense of structure. Minimalism is also emphasized in the fine details such as its narrow wall cabinet system, simple layout and integrated handle design. The image overall produces the impression of coolness and oozes out an ambience of sharpness.



SAMPLE
OPPEIN



STARRY PLCC22195

UV Lacquer

Door Style: YMC003, YMA001

Door Finish: UV Lacquer PWMC0110, PWMC0111+Melamine PWMA0356

Countertop: PWTE0067

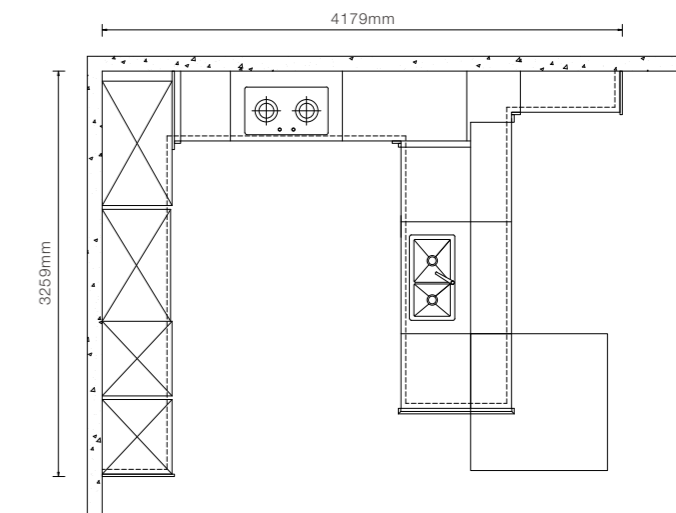

SAMPLE
OPPEIN



CADDO PLCC21347

UV Lacquer

Door Style: YMC003

Door Finish: UV Lacquer PWMC0064, PWMC0029

Countertop: PWTY1008

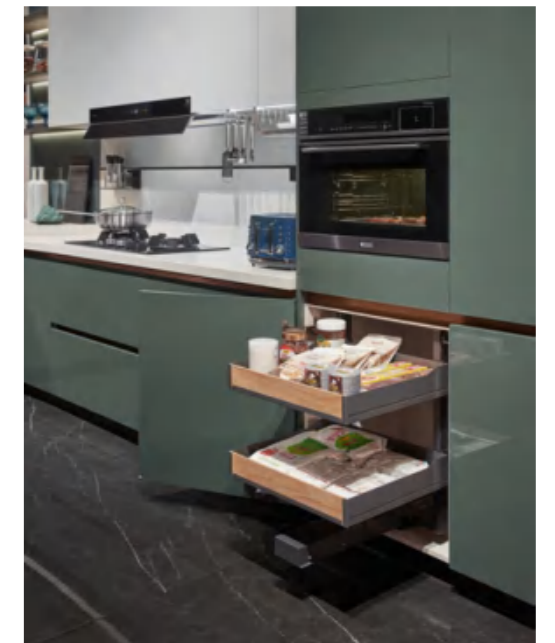
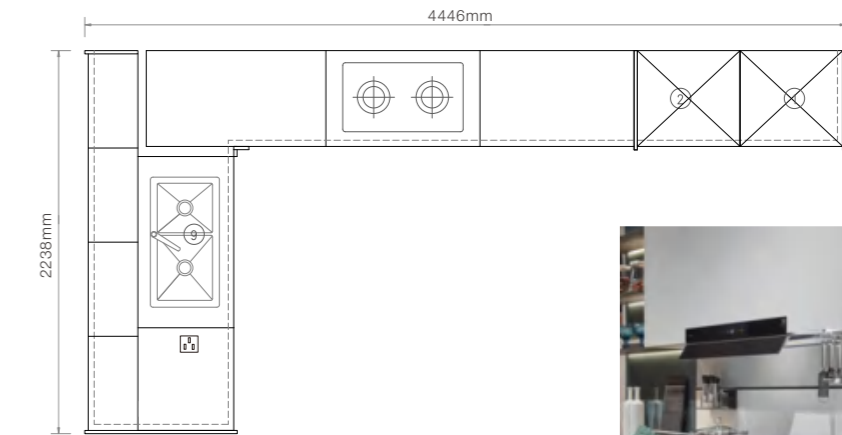

Green and white combine to create a secret forest enveloped in mist. Mirror-like surface reflects lights like sparkling fireflies at night. Also, there are several convenient designs that emphasizes its practicability. It will effectively assist you for cooking or storage with L-shape open design, integrated drawer and rebound door. Such a delightful decor to refresh your home.





SHERWOOD PLCC21182

Melamine

Door Style: YMA009, YMA001

Door Finish: Melamine PWMA0212, BWMA0025

Countertop: PWTY1078

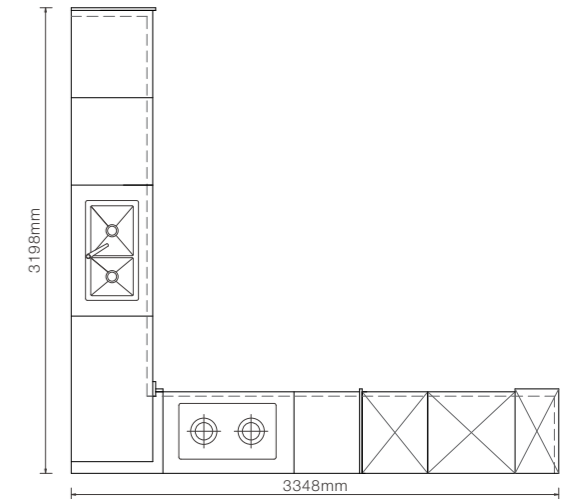

The visual style of Sherwood is a triumph of modern minimalism. Rational layout and divisions together carry out a clean look. Open metal shelves and wall cabinets have come to frame the space, a shade of light grey softening the outline of the kitchen. It is a blend of modernism and extreme simplicity. Pure white units in the middle is an extra stroke to bring a touch of splendour and glamour into the house.



MEDELLIN PLCC22054

Melamine

Door Style: YMA001

Door Finish: Melamine PWMA0353, PWMA0354

Countertop: PWTE0049

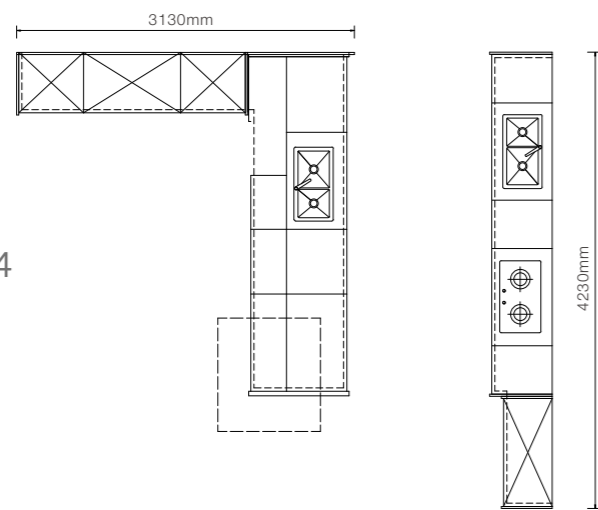



CAMON PLCC22046

Melamine

Door Style: YMA001

Door Finish: Melamine PWMA0350, PWMA0351, PWMA0215

Countertop: PWTY1092

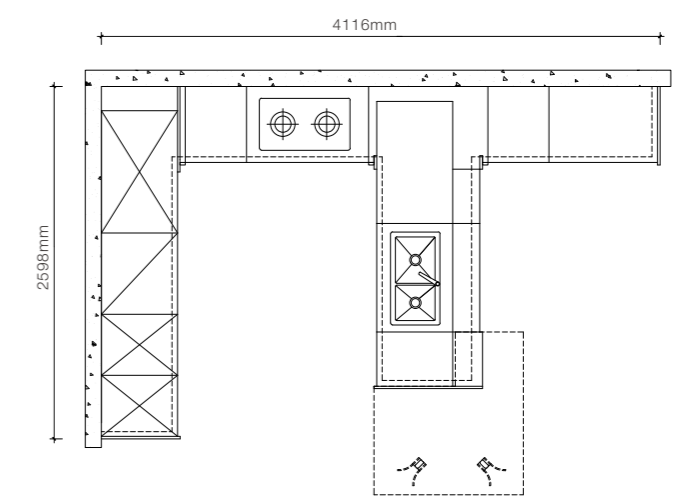



BANDARI PLCC21413

Melamine

Door Finish: Melamine PWMA0258, PWMA0259
Countertop: PWTE0034

Metallic blue door panels is in total contrast to the lightness of the grained oak ones, which lends a glaring intensity to the contours of the kitchen. Not only does it highlight the contours of the front faces and lines, but also it depicts the beauty of nature and new modernism. Bandari possesses exquisite qualities that appeal to a refined taste. Living in a house with it, can literally get you into real relaxation the way you would feel when listening to Bandari's piano music, soothing and slow.

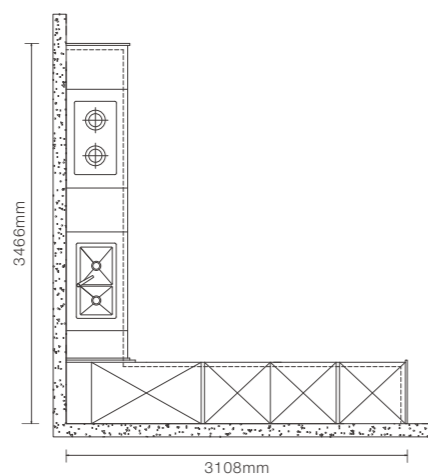



ELLIS PLCC20093

Melamine

Door Style: YMA001

Door Finish: Melamine PWMA0131, PWMA0113

Countertop: PWTY1018

With various space levels and its simple layout set up, stylish wood grain texture and pure white door panels make up a harmonious scene, which conveys a sense of elegance and comfort. Chests of wood grain drawers reinforces its Nordic style. Its wall-mounted system also serves a practical purpose in terms of optimizing the space utilization and enriching its functionalities.

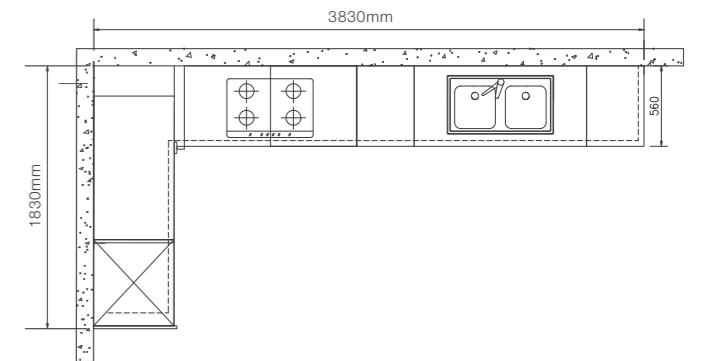

STARTO PLCC22037

Melamine

Door Style: YMA079, YMA001

Door Finish: Melamine PWMA0360, PWMA0352

Countertop: PWTE0068

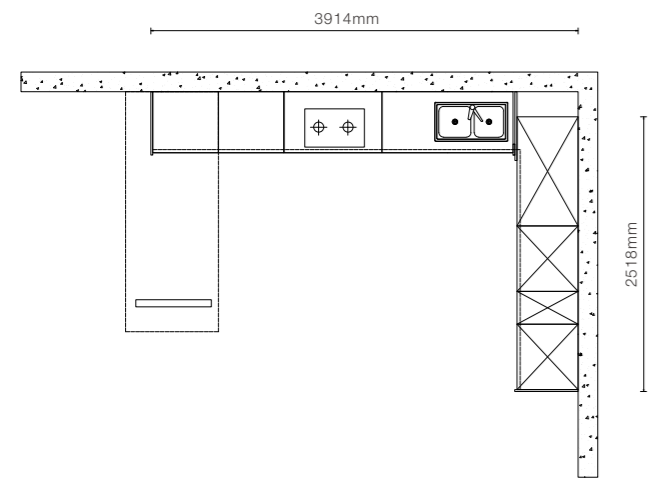



MONT BLANC PLCC18021

Melamine

Door Style: YMA001

Door Finish: Melamine PWMA0060, PWMA0103

Countertop: PWTY1032

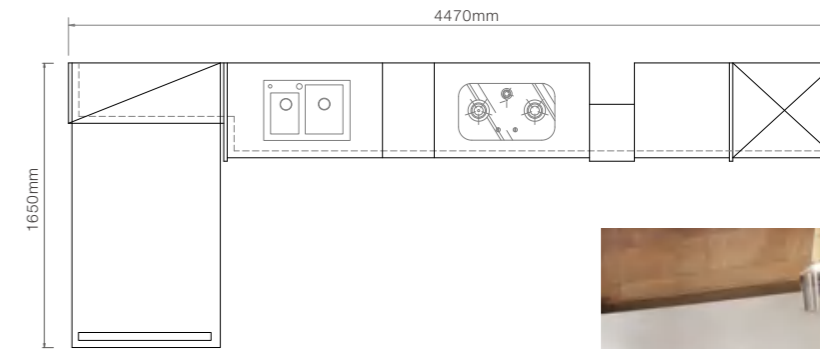

It comes out with its simple layout and a soft shade of color, modern and stylish. This picturesque design has formed a new kitchen concept of exquisiteness, elegance and coziness.



GLUCK PLCC21412

Melamine

Door Style: YMA001

Door Finish: Melamine PWMA0256, PWMA0257

Countertop: PWTY1077



Our relentless pursuit of modernism and minimalism in design, is a tribute to Gluck's attitude towards his music. That is to stay true and simple. Golden oak grain coupled with matte plain stone texture, creates a warm look for the house, add a touch of sophistication and elegance. The company of a good kitchen can restore your mind to tranquility and sedateness.

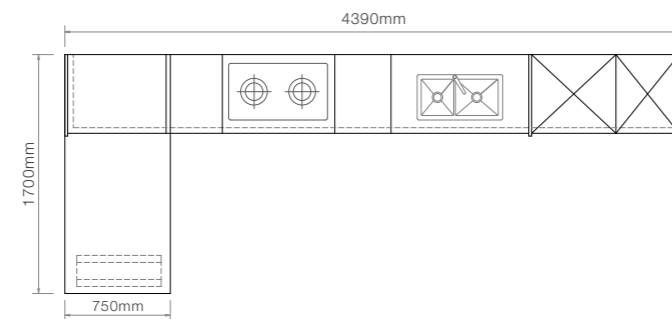



NOTTING HILL PLCC21409

PVC Foil

Door Style: YMG116, YMG002, YMA001, YMK001

Door Finish: PVC foil PWMG0210, PWMG0209

Countertop: PWTE0022

Notting Hill is another example of a spacious kitchen with PVC coated units and good natural light. Polished surface resonated with titanium golden color tone, just brightens up the room immediately and adds softness to the look. This tends to be more reserved and warm compared to typical industrial styles, allowing it to cover a wide range of interior decorating, being more widely acceptable by people.

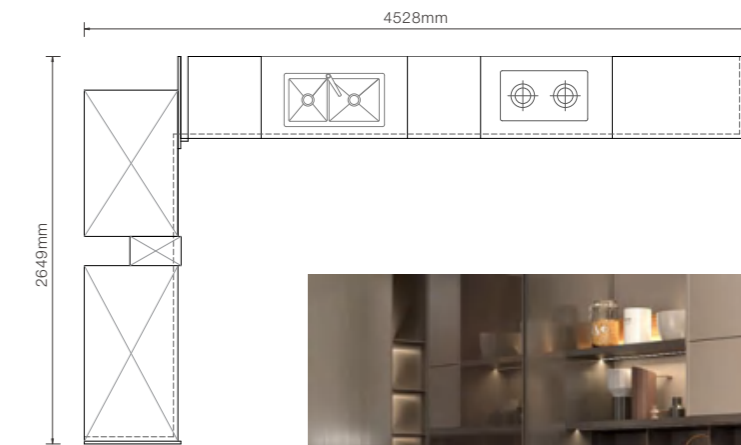

SAMPLE
ORPEIN

MANZANILLO PLCC20101

PVC Foil

Door Style: YMG088 Door Finish: PVC PWMG0061

Countertop: PWTY1031

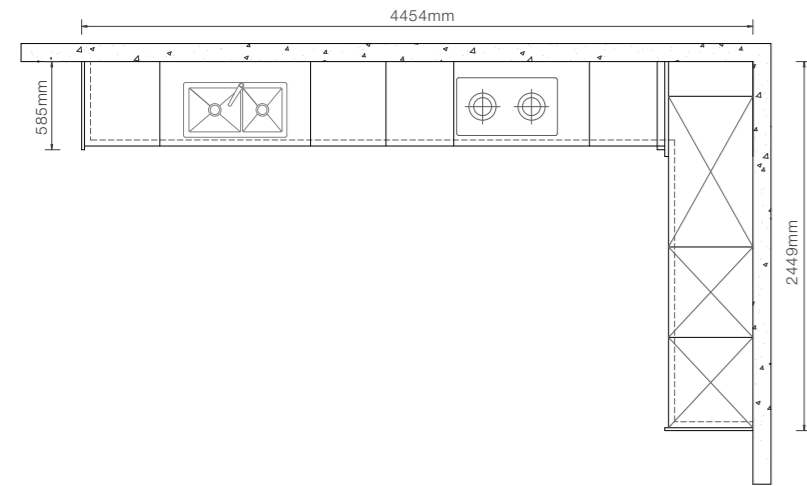

Simple and elegant lines of the doors make the cabinet look clean and graceful, the high-class white material gives it more aesthetic intension, and the striped glass makes it clear and clean. Light white PVC foil matches the brushed brass elements nicely. Exquisite and high-class PVC material with its matt and soft texture could fit a variety of decorative styles.



SAMPLE
OPPEIN



CEZANNE PLCC22092

PVC Foil

Door Style: YMG168, YMG167

Door Finish: PVC PWMG0254, PWMG0255+Melamine PWMA0269

Countertop: PWTE0048

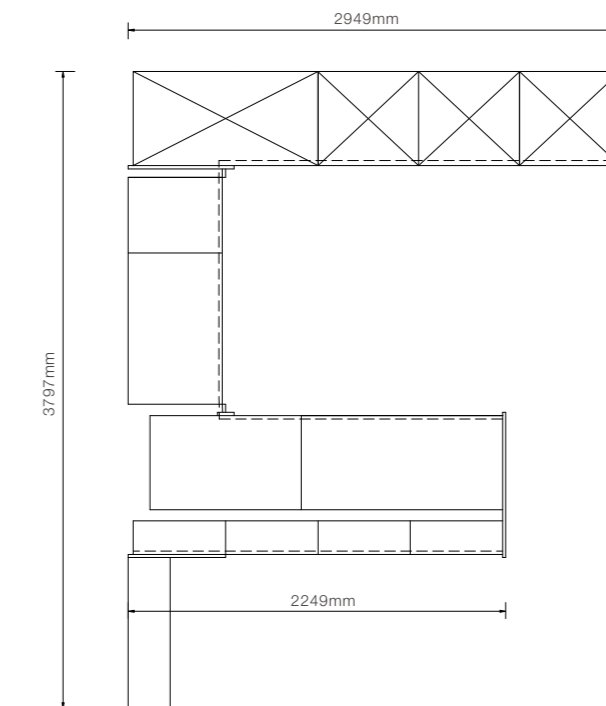

SAMPLE
OPPEIN

BERNARD PLCC22094

PVC Foil

Door Style: YMG174, YMG175

Door Finish: PVC PWMG0260, PWMG0261

Countertop: PWTE0070

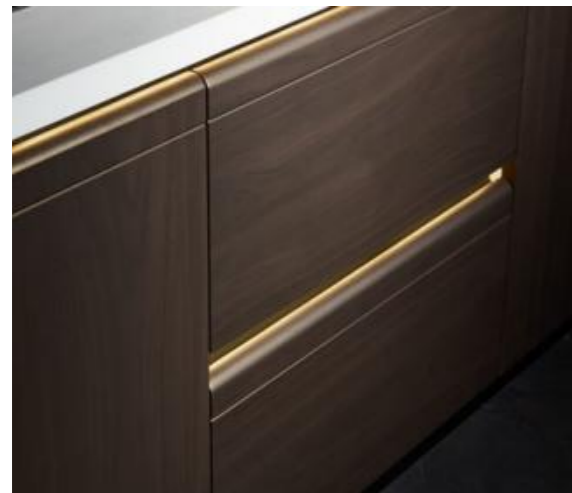
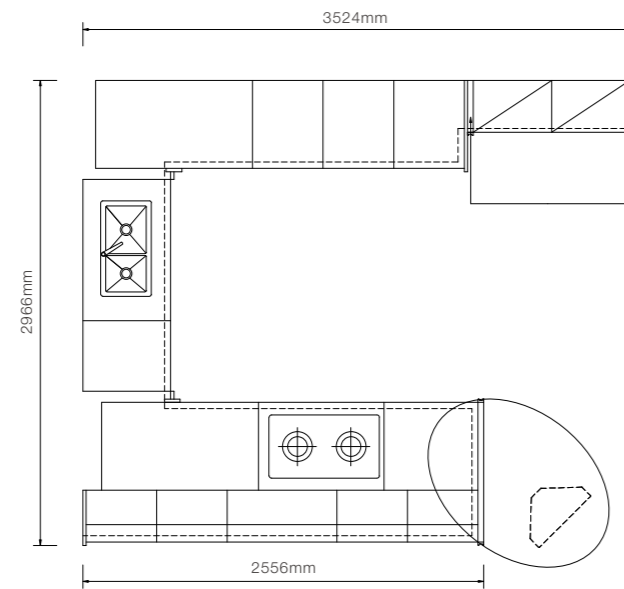

SAMPLE
OPPEIN



DEWROMA PLCC22101

PVC Foil

Door Style: YMG170, YMG171, YMG172, YMG139
 Door Finish: PWMG0257, PWMG0266, PWMG0258
 Countertop: YTE001G/YTE008, PWTE0030

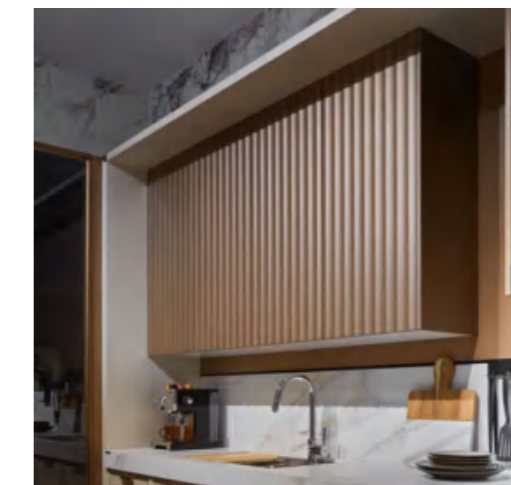
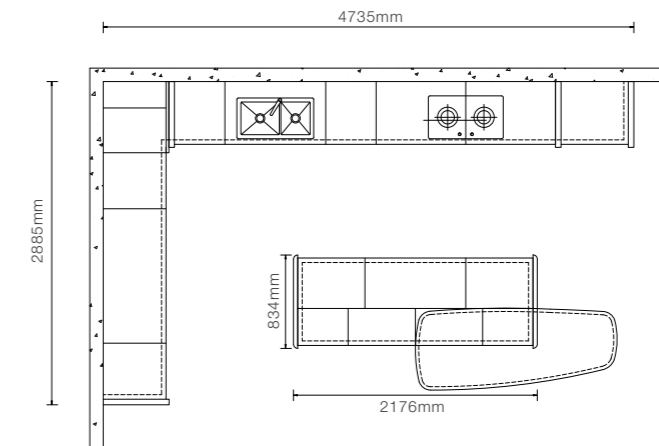

SAMPLE
OPPEIN

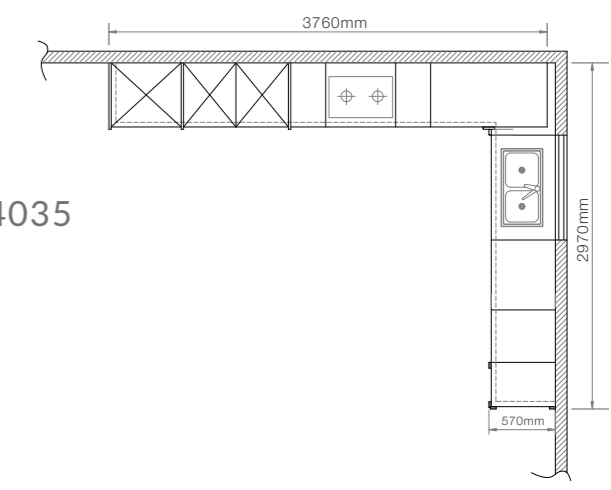

NICAEA PLCC14035

PP Foil
 Door Style: YMD007
 Door Finish: PP Foil PWMD0005
 Countertop: PWTY1011



People who live in the teeming city now tend to seek a simpler and happier life, clinging to "Back to nature, back to origin" living philosophy. Nicaea is the type of kitchen that every family desires. The antique and delicate solid wood leads you closer to nature, bringing you back to the old times, and casting an air of gentility and elegance to your house.

PREMIUM

CARCASE PANEL | 15mm thick plywood, four edges sealed with 1mm thick PVC.

BACK PANEL | 3mm thick MDF, both faces coated with melamine.

WOODEN SHELF | 15mm thick plywood coated with HPL, front edge sealed with 1mm thick REHAU PVC.

GLASS SHELF | front edge sealed with aluminum, stylish.

DRAWER PANEL | same as carcass panel, edges sealed with 0.6mm thick REHAU PVC

GLASS SHELF | front edge sealed with aluminum, stylish.

KICKBOARD | material can be aluminum, plastic, HPL, PVC or wood veneer. And colors can be black, silver or white, or customized to be coordinated with doors.



STANDARD | ECONOMICAL

CARCASE PANEL | 16mm thick particle board, four edges sealed with 1mm thick PVC.

BACK PANEL | 3mm thick MDF, both faces coated with melamine.

WOODEN SHELF | 16mm thick particle board coated with melamine, front edge sealed with 1.5mm thick REHAU PVC.

GLASS SHELF | front edge sealed with aluminum.

DRAWER PANEL | same as carcass panel, edges sealed with 0.6mm thick REHAU PVC.

KICKBOARD | material can be aluminum, plastic, HPL, PVC or wood veneer. And colors can be black, silver or white, or customized to be coordinated with doors.

CARCASE PANEL



7-layer Plywood

- ◆ 7 layers solid wood sheets, dispartch the stress 40% loading capacity higher than other carcass material.
- ◆ Strong screw holding capacity to keep structure stable and long lasting service.
- ◆ 0.6mm thick laminate on both faces, heat and moisture resistant.
- ◆ Formaldehyde emission $\leq 1.5\text{mg/L}$, eco-friendly and complying with European class E1 standard.



PVC Edging

- ◆ Front edge is sealed with 1.2mm thick PVC by HOMAG edge bander with extreme accuracy and precision while other side edges are sealed with 0.5mm thick PVC.
- ◆ JOWAT eco-friendly seal adhesive to guarantee tight seal and eco-friendliness.



Particle Board

- ◆ Wood chips cold pressed by 300 tons/m² with superior screw holding capacity and load bearing capacity.
- ◆ Keeping stable structure and long lasting service.
- ◆ Easy to clean and protect the carcass from chemical injury.
- ◆ Formaldehyde emission $\leq 1.5\text{mg/L}$, eco-friendly and complying with European class E1 standard.

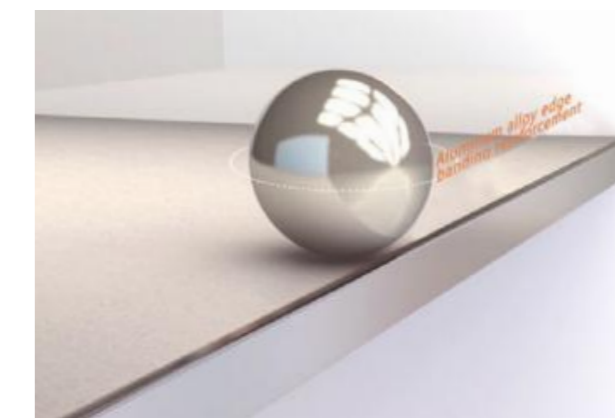

Glass Shelf Edging

- ◆ Glass shelf edge sealed with oxidated aluminum.
- ◆ Vogue and can keep round objects from slipping off.

CARCASE HARDWARE



Top Panel Connector

- ◆ To joint 45° cut crown molding, made from stainless steel.
- ◆ Rustless and extremely durable, allowing tight joints.

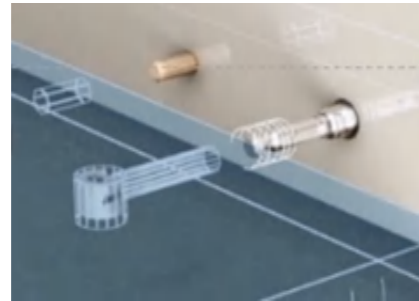

TITUS Quickfit Dowel and Sleeve Set

- ◆ 2 in one, high resistance to torsion and dowel pull out.
- ◆ Never loosen through time and ensure rigid construction.

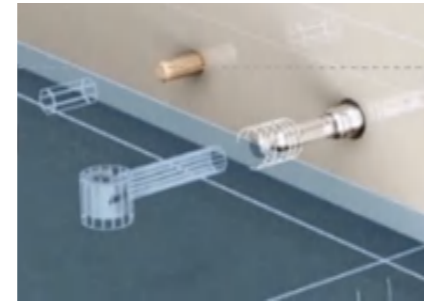

Hardwood Dowel

- ◆ Sturdy and long lasting, Ø8*30mm



Adjustable Leg

- ◆ Made from PP, each leg to bear 100KG weights, more than 20 years of service life.
- ◆ Leg length can be 80mm, 110mm, 130mm and 160mm.

CARCASE HARDWARE

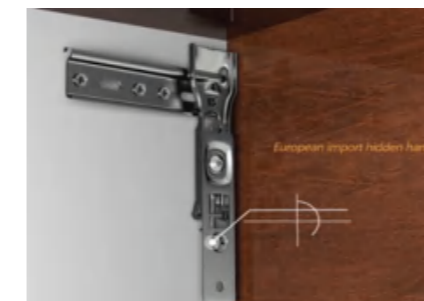

Suspension Bracket Invisible

- ◆ HETTICH suspension bracket, 110KG loading capacity/set, durable and safe



Suspension Bracket Visible

- ◆ Made from nickle plated steel/ABS and withstanding 24hrs of salt test.
- ◆ Patented locking design to keep cabinets from slipping off.
- ◆ 65KG/pc powerful loading capacity.

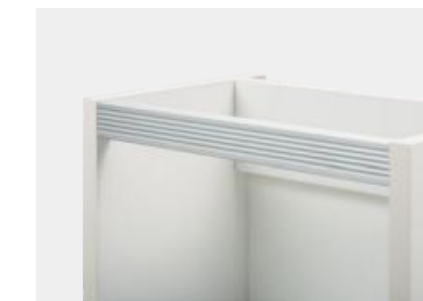

Aluminum Crossbar

- ◆ Instead of wooden crossbar, OPPEIN base units are mounted with aluminum crossbar, which can greatly reinforce the cabinet structure, support and protect your countertop.



Idle Hole Insert

- ◆ Made from food-grade plastic. Various colors optional to be harmonious with carcass interiors.
- ◆ To avoid moisture entry into holes.



Kpush-Tech Door Rebounder

- ◆ From ITALIANA FERRAMENTA, withstanding 80,000 fatigue tests.
- ◆ Perfect new silent automatic opening system for doors without handles or knobs.



Hettich/blum Hinges

- ◆ Made from stainless steel, nickle finished, or zinc alloy.
- ◆ Withstanding 200,000 cycle tests, to allow silent motion due to the mute dampener.



Cobra Glass Shelf Pin

- ◆ From ITALIANA FERRAMENTA, zinc alloy material, nickle finished, enhances the look of your cabinets.
- ◆ Nylon screw to allow to lock the glass shelf safely in place.



Waterproof Kickboard and Clips

- ◆ Kickboard made from aluminum, plastic or wood.
- ◆ Colors can be white, grey, black, silver, or wood grain colors to match your cabinets.
- ◆ High quality plastic fasten kickboards with adjustable legs tightly.



Rubber Buffer

- ◆ Mounted on door fronts to offset impact when door closing.
- ◆ To protect door fronts and avoid noise.



Wall Mounting Fitting

- ◆ German FISHER screw and anchor.
- ◆ Withstanding 24 hours of salt test, rustless and corrosion resistant.
- ◆ To keep wall units firm fastened, loading capacity of each anchor ≥800N.

CARCASE HARDWARE



Aluminum Foil Of Sink Cabinet

- ◆ Bottom panel of sink cabinet is coated with aluminum foil, and edges are sealed with waterproof strip inserts, which keep cabinet from absorbing water.
- ◆ Aluminum foil has stylish looks and easy to clean.

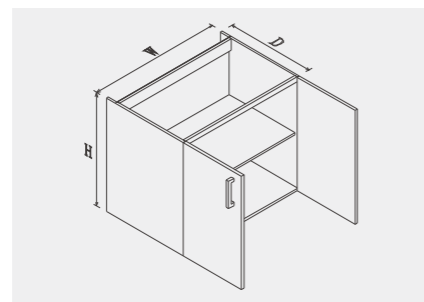

22mm Gap Between Backpanel And Wall

3mm thick MDF back panel is inserted into the groove of side panels, a 22mm thick gap are left between protruding side panels and back panels allows air ventilation, and thus back panels will not absorb moisture from wall, will not swell and ensure long service life.



Ventilation Grill

Stainless steel, installed in stove cabinet to keep cabinets ventilation.

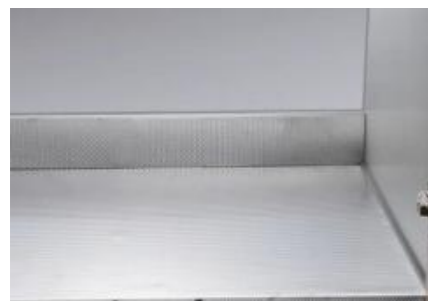

Waterproof Strip Insert

Waterproof strips are inserted in the edges of sink cabinet to keep particle board from absorbing moisture.



Undersink Aluminum Supports And Rails

- ◆ Under the sink, 10pcs of aluminum supports are arranged, which help support the weights and impacts evenly from sink and protect your countertops.
- ◆ Also, 3 pcs of aluminum rails are installed on the back side to offset the weights from worktop evenly.

DOOR FRONTS



Solid Wood

- ◆ Genuine broadleaf wood imported from North America, with rich, natural and clear wood grain, stunning linear texture
- ◆ 6 popular wood species optional including birch, cherrywood, alder, oak, ash and walnut.
- ◆ 8~12% moisture rate, not liable to distort or rupture
- ◆ Outstanding bending resistance; High scratch resistance and intensity.
- ◆ Good workability, sleekly section, good water resistance and adhesion performance.
- ◆ Lumber supplied by MATSON LUMBER COMPANY and GUTCHESS LUMBER, both are the world's best hardwood manufacturers in North America.
- ◆ Segment: premium



Lacquer

- ◆ 18/21/25mm thick MDF as core
- ◆ Eco-friendly lacquer are supplied by PPG and DAIHO, both are paint industry leaders in the world
- ◆ Superior yellowing resistance and weatherability to avoid discolor.
- ◆ Hardness is as high as 1.8, bringing outstanding scratch resistance.
- ◆ Matt or high gloss surface optional.
- ◆ Metallic lacquer optional, which is added silver powder to get metallic shiny surface.
- ◆ Segment: high and middle-end.



PVC foil Coated

- ◆ 18/21/25mm thick MDF as core, seamless frame and core structure
- ◆ Front face coated with PVC, back face coated with white melamine
- ◆ PVC foils are supplied by RIKEN and RENOLIT, both are world-leading decor foil manufacturer High quality PVC foil, mainly supplied by Renolit and Riken
- ◆ Applying JOWAT eco-friendly glue
- ◆ Fine and beautiful wood grain
- ◆ Tough surface, superior scratch resistance
- ◆ Alternative for genuine wood



PP Foil Coated

- ◆ 21/25mm thick MDF as core
- ◆ Frame and core structure, both faces coated with PP foil
- ◆ PP foil has astonishingly excellent wood grain and texture, and it is the best alternative for genuine wood
- ◆ Classical looks same as genuine wood, but with outstanding price performance
- ◆ Segment: high and middle-end

DOOR FRONTS



Acrylic

- ◆ 18mm thick MDF/particle board as core
- ◆ Front face coated with inked acrylic, back face same as front face, or laminated with ABS décor paper
- ◆ Edges sealed with same-color acrylic
- ◆ Scratch resistant and easy care
- ◆ Excellent alternative for lacquer
- ◆ Segment: middle-end and economical



High Pressure Laminate

- ◆ 18mm thick particle board as core
- ◆ Edges sealed with 2mm thick REHAU PVC
- ◆ The decorative paper is 0.6~0.8mm thick, outstanding scratch and heat resistance
- ◆ Scratch resistant and easy care
- ◆ Segment: economical



Melamine

- ◆ 18mm thick particle board as core
- ◆ Edges sealed with 2mm thick REHAU PVC
- ◆ Both faces coated with high quality German SCHATTDECOR or SPAIN LAMIGRAF impregnated décor paper
- ◆ Natural colors or monocolors optional, fine texture
- ◆ Scratch resistant and easy care
- ◆ Segment: economical

COUNTERTOP



Caesarstone

- ◆ Imported from Israel.
- ◆ Eco-friendly and nonporous material.
- ◆ Scratch and wear resistant, antibacterial and easy to clean.
- ◆ Made of quartz, requiring minimal maintenance, no need to seal or wax, heat and aging resistance.



Counter Processing

- ◆ Countertop processed by imported Germany sophisticated machines.
- ◆ Slab precisely cut by advanced laser bridge cutting machine, tolerance within 0.5mm.
- ◆ High efficient water-jet CNC cutting machine used for cutting, hole boring and irregular profile moulding.
- ◆ Countertop profile moulded and polished by imported CNC center, insuring precise and high quality.

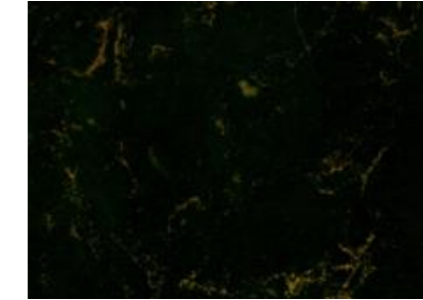

Silestone

- ◆ Imported from Spain. Made up of 94% natural quartz
- ◆ Hard and resilient, stain resistant, acid resistant, scratch resistant and heat resistant
- ◆ Impact resistant, bacteriostatic protection, can contact with food directly. Beautiful textures, high-end



Undermount Technics

- ◆ Dupont green glue used to fix sinks, 14 scientific progresses.
- ◆ No annoying glue residues, sleek and easy cleaning.
- ◆ Extra cross bars are in position to avoid possible countertop splitting or distortion.
- ◆ The bearing capacity is twice that of topmount.



Oppein Quartz Stone

- ◆ Outstanding scratch & impact resistance performance.
- ◆ Non-porous and highly stain-resistant to stains, such as wine, vinegar oil.
- ◆ Flame retardant, heat resistance (as high as 300°)
- ◆ Superior aging resistance; Nontoxic and no radiation.
- ◆ Minimal maintenance



Aluminum Cross Bars

- ◆ 3 horizontal aluminum bars are smartly designed to bear the weight from countertop equally, avoiding possible countertop splitting or distortion caused by uneven weight.
- ◆ Especially, at the back side of stove opening and sink opening, extra aluminum bars are in position to equally absorb countertop weight.

ERGONOMIC PLANNING

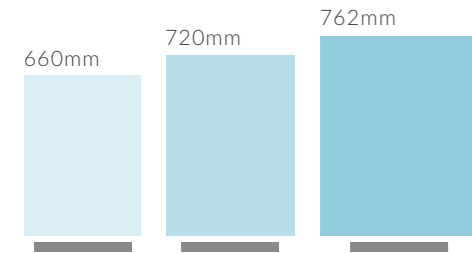

3 Heights Of Base Units

Multiple height choices, suitable for people with different heights.

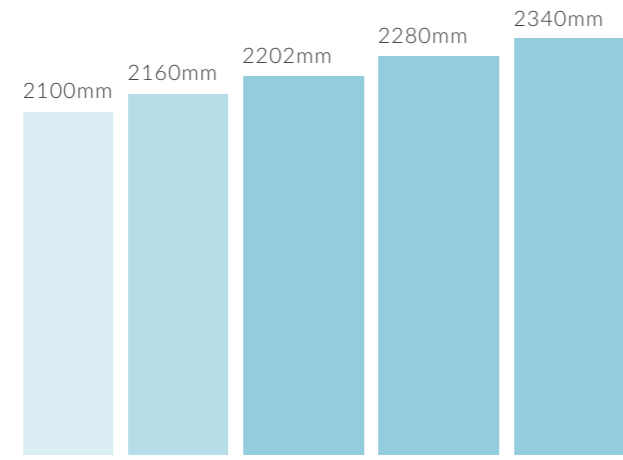

5 Heights Of Pantry

Can be chosen freely, matching with multiple pull-outs, make reasonable use of high cabinet space. Ingenious design hides the appliance skillfully and keep the kitchen style unified.

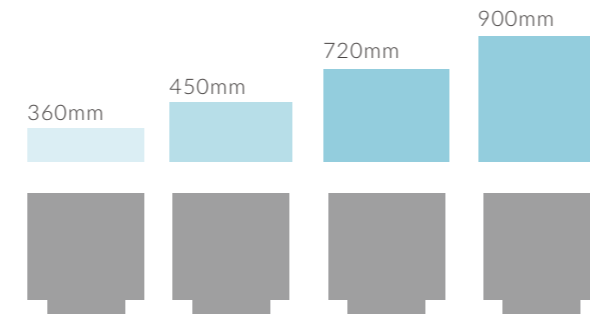

4 Heights Of Wall Units

Accurate and user-friendly height, make good use of the upper space, matching with step ladder, easy to access. Optional concealed handle, can avoid knock against efficiently.

ERGONOMIC PLANNING

The basic rule of kitchen triangle is applied in each OPPEIN kitchen design. The primary task in a kitchen are carried out between the cook top, the sink and the refrigerator. These three points and the imaginary lines between them make up what kitchen experts call the work triangle. The idea is that when these three elements are in close (but not too close) proximity to one another, the kitchen will be easy and efficient to use, cutting down on wasted steps.

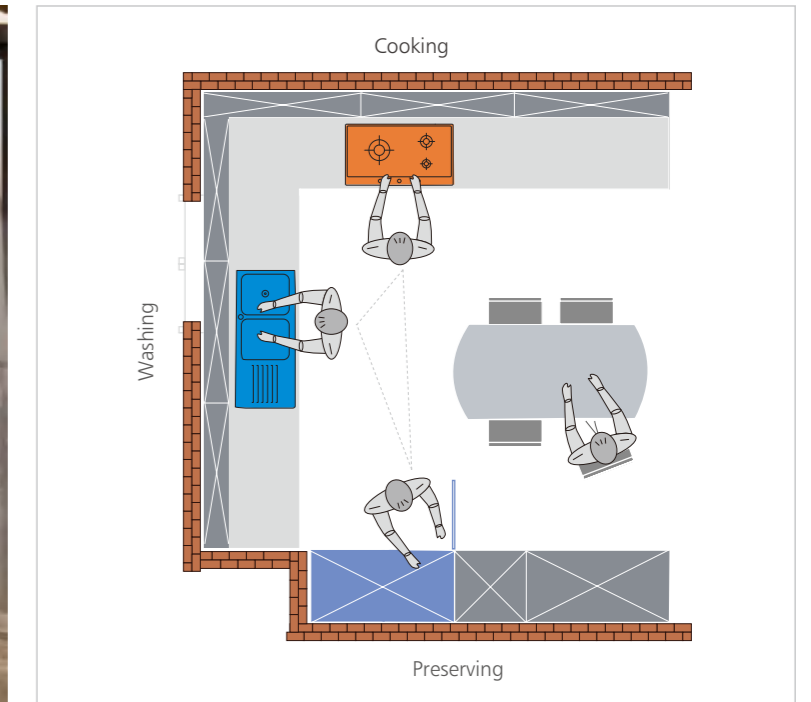

WALL FUNCTIONAL FITTINGS



Aventos HF With Servo-drive

AVENTOS HF works with two-part, bi-fold doors that fold in the center when opening. It is an ideal solution for tall wall cabinets with large doors because the handle stays within easy reach. With Servo-drive, doors can be opened with a simple touch, and a press of the switch ingrated into the carcass side panel, door closed again.



Aventos HS

AVENTOS HS lift systems open doors up and over the top of the cabinet, and they are ideal for wide cabinets with heavy, single doors.



Aventos HK-XS

AVENTOS HK-XS is a smaller, cost-effective lift system for shallow wall cabinets, like those above refrigerators and pantries. Its variable stop feature allows the door to stay in any desired position, so it's always within reach.



Aventos HK-S

With AVENTOS HK-S lift systems, you get the same operation of AVENTOS HK, but in a smaller package. These lift systems have been specifically designed to snugly fit in smaller cabinets, and they excel above refrigerators and pantries.



Aventos HL With Servo Drive

AVENTOS HL lift single doors parallel to the cabinet. It works great in kitchens with high ceilings, and crown molding will not be a problem because of the motion of the door. AVENTOS HL is also an ideal solution for a counter top appliance garage.

MAGIC STORAGE SYSTEM

Base Units

Everybody wants to have more storage in the kitchen. By reasonable layout, OPPEIN magic storage system can improve your storage space by 30%. Everything will find its place, no space is wasted.

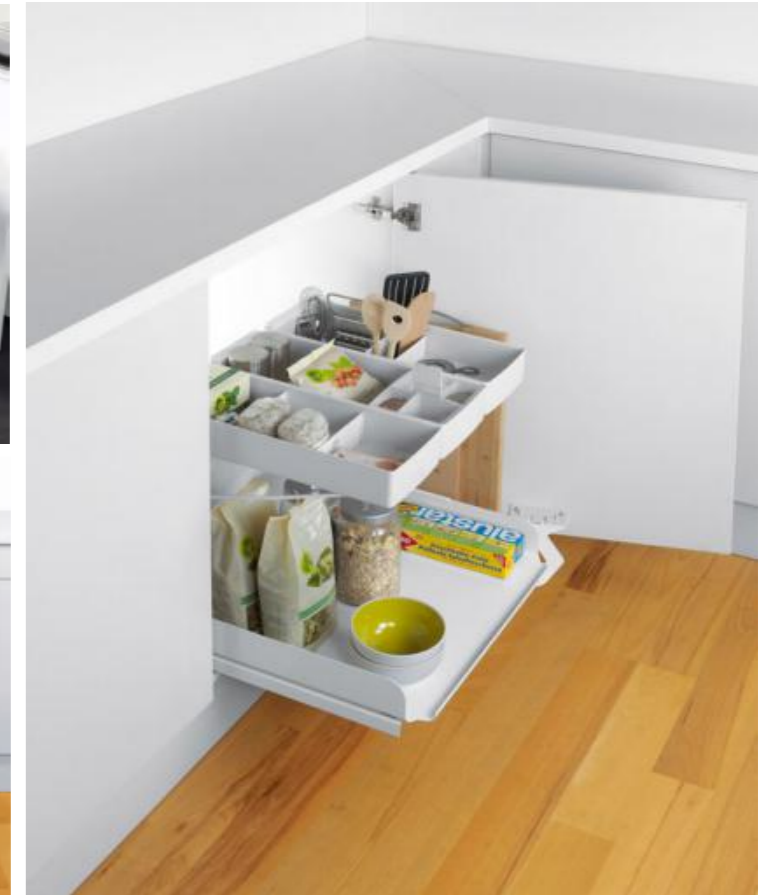
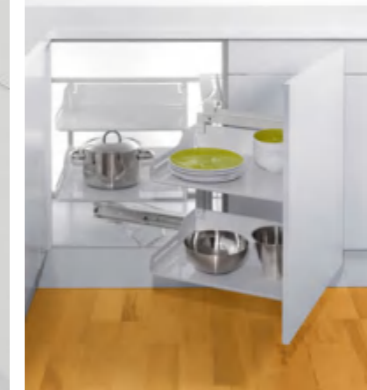

MAGIC STORAGE SYSTEM

Pantry Units

No matter tandem or pull outs, our pantry pull outs always make best use of available space, and supports good organization and fast access. All the contents, even on the topmost shelf, are in clear view. Meanwhile, the built-in damping system can keep operation noiseless.



MAGIC STORAGE SYSTEM

Wall Units

Pull down the pull outs, you can easily access your storage in the wall or top of the high pantry. Still, the optimal layout makes full use of the space and makes storage tidy.



MAGIC STORAGE SYSTEM



Drawer Interior

The clever design of these drawer dividers means you can easily adjust them as you add and remove items from the drawers, keeping the contents upright, accessible and tidy.

Drawer dividers ensure you get the best possible use of the drawer space. No more clutter. The kitchen drawer dividers also simplifies preparation of your shopping list.



LIGHTING SYSTEM

Different types of down lights, strip lights and shelf lights, drawer lights and inductive lights offer not only additional illumination, but also create a happy mood in your kitchen.

Our lights are harmonious with your kitchen space, and high quality LED strips or bulbs allow long service life and bring energy saving.





Quality Control

All our panels comply with emission class E1 , pass tests with European chamber method EN717-1 , and meet the stringent California Air Resources Board (CARB) emissions standards. Silestone, Caesarstone and other imported quartz stone are all Greenguard certified And OPPEIN self-manufactured quartz stone is NSF certified.

CONTROL OF HAZARDOUS SUBSTANCES

Panels and Paints

Substances Test Standards Material	Formaldehyde Emission					Soluble Pb	Soluble Cd	Soluble Cr	Soluble Hg	Soluble Methanol
	China GB18584-2001	EU EN717-1:2004	USA ASTM D 6007:2014	Japan JIS A 1460-2015	Australia AS/NZS 4266.16:2004					
MDF	≤1.5mg/L	≤0.124mg/m³	≤0.13ppm	≤0.3mg/L	≤0.5mg/L	—	—	—	—	—
Particle board	≤1.5mg/L	≤0.124mg/m³	≤0.09ppm	≤0.3mg/L	≤0.5mg/L	—	—	—	—	—
Plywood	≤1.5mg/L	≤0.124mg/m³	≤0.05ppm	≤0.3mg/L	≤0.5mg/L	—	—	—	—	—
Test Conclusion	Compliant	Class E1 compliant	Compliant	F4 compliant	Class E0 compliant	≤90mg/kg	≤75mg/kg	≤60mg/kg	≤60mg/kg	≤500mg/kg

Countertops

Item Material Type	Internal exposure index (IRa)	External exposure index (Ir)	Median lethal dose (LD50)
OPPEIN quartz stone	≤0.6	≤0.8	> 5000mg/kg
Solid surface	≤0.6	≤0.8	> 5000mg/kg
Imported quartz stone	≤0.6	≤0.8	> 5000mg/kg

Adhesives

Item Material Type	Free formaldehyde	Benzene	Methylbenzene & dimethylbenzene	Halohydrocarbon	TVOC
Adhesives	≤100mg/kg	≤100mg/kg	≤500mg/kg	≤500mg/kg	≤50g/L

ADVANCED TECHNOLOGY



No-added Formaldehyde-antibacterial Green Panel

- Formaldehyde Emission $\leq 0.03\text{mg}/\text{m}^3$
- The eco-friendly protection standards of OPPEIN far exceed European standards ($E1 \leq 0.124\text{mg}/\text{m}^3$, $E0 \leq 0.05\text{mg}/\text{m}^3$)
- The Green Panel of OPPEIN obtains NAF certification, which is the top level of environmental grade.

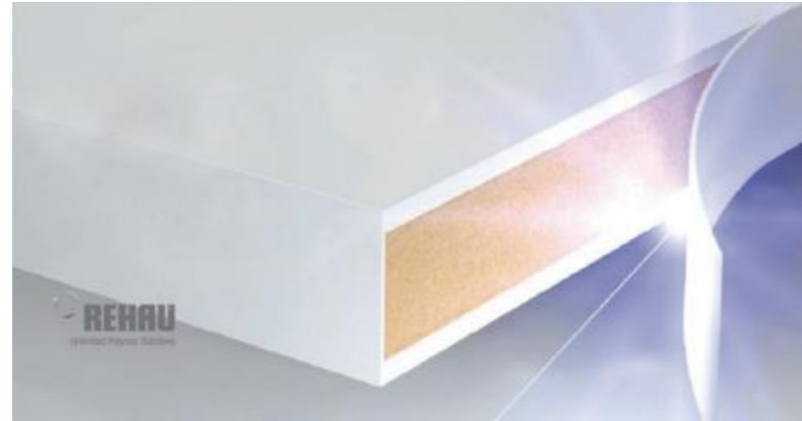

Germany laser edge banding technology

- The laser edge banding layer is used instead of the glue edge banding, which is more durable and environmentally friendly.



Integrated PP process

- The interior of the 12mm drawer adopts the overall PP process without an edge banding glue line, which is more exquisite, environmentally friendly and wear-resistant.



Spray lacquer process

- No moisture in the panel



Continental rabbet back panel

- The technology of continental rabbet keeps the back panel and the wall at a ventilation distance, which is good for moisture resistance and easy for secondary disassembly and assembly.
- The back panel buckle connection process enhances the stability of the cabinet.



Buffer hinge

- Upgrade Italian SALICE door hinge, privacy built-in double damping structure.
- The damping action angle can be adjusted as required.



Inkjet printing process

- A variety of color options and healthy and environmentally friendly.
- It is non-toxic and odorless, tested by SGS, and does not contain heavy metals, creating a healthy environment for children.



Imported Finishes

- More durable, more beautiful, more comfortable

QUALITY CONTROL



CARB Certification

Formaldehyde is produced on a large scale worldwide. One major use includes the production of wood binding adhesives and resins. In 2009, the California Air Resources Board (CARB) released the toughest formaldehyde emission regulations for composite wood products. OPPEIN takes formaldehyde emissions very seriously and all panels we purchase CARB-certified.

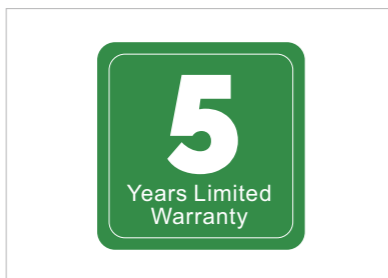

5 Years Limited Warranty

Cabinets manufactured by OPPEIN HOME GROUP are warranted to be free from defects in material and workmanship under normal use to the original consumer purchaser for a period of five years from the date of purchase.



NSF Certification

Our quartzstone is endorsed by the National Health and Safety Foundation (NSF) in accordance with international NSF 51 sanitary standards, and they are qualified for installation in hospitals, restaurants, hotels and more.

QUALITY CONTROL

We oversee every process that affects quality, such as:

- ◆ Supplier selection and assessment
- ◆ The quality of raw material, spare parts and finished products
- ◆ Product design and development
- ◆ Shipment and installation
- ◆ Documentation management

Every year, OPPEIN conducts more than 500 tests in its well-equipped test labs and the third party testing bodies.



Yellowing Tester



Salt Spray Tester



Constant Temperature and Humidity Chamber

KITCHEN CABINET PACKING PRE-ASSEMBLED PACK



Check whether the unit assembly is qualified



Use EVA foam to protect the corners of the unit



Cover cardboards on six sides



Seal the carton with tape



Label the carton with shipping mark



Tighten the cabinet with belts

KITCHEN CABINET PACKING FLAT PACK

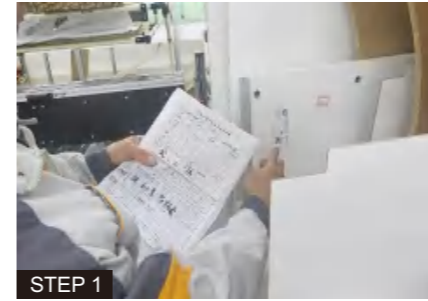

Check order information



Panel transfer



Place honeycomb-paper cardboard at the bottom



Put the panel in the middle



Place the cardboards on the top



Determining the packing size



Cut the cartons into suitable size



Fill with honeycomb-paper cardboards, protect the four corners with EVA foam



Seal the carton with tape



Label the carton with shipping mark

COUNTERTOP PACKING



Wrap the countertop with an air column bag for shock absorption



Cut the coaming following the countertop size



Clamp the package U-shaped wooden guard strips to the countertop with the countertop packaging machine



Nail the front plate.No exposure



Tighten the countertop with plastic belts



Label the carton with shipping mark



Complete packing